



LICENSING ACT 2003

PREMISES LICENCE

Schedule 12

Part A

Part 1 Premises details

Premises licence number
CYC - 009267

Postal address of premises:

52 Low Petergate

Post town: **York**

Post code: **YO1 7HZ**

Telephone number: 01904 673293

Expiry date: This licence has no expiry date.

Licensable activities authorised by the licence:

Recorded Music
Late Night Refreshment
Supply of Alcohol

The times the licence authorises the carrying out of licensable activities:

See Annex 1 – Embedded Restrictions

The Opening Hours of the Premises

No Restrictions

Where the licence authorises supplies of alcohol whether these are on and/or off supplies:

On and off the premises

Part 2

Name, (registered) address, telephone number and email (where relevant) of holder of premise licence:

Name: Jimmys York Limited

Address: First Floor
17-19 Foley Street
London
W1W 6DW

Telephone number: none

Email address: None

Registered number of holder, for example company number, charity number (where applicable):

12882634

Name, address and telephone number of designated premises supervisor where the premises licence authorises for the supply of alcohol:

Name: Andrea Gaiga

Address: [REDACTED]
[REDACTED]

Telephone number: None

Personal licence number and issuing authority of personal licence held by designated premises supervisor where the premises licence authorises for the supply of alcohol:

City of York Council
CYC - 65832

Annex 1 – Mandatory conditions

MANDATORY CONDITIONS IN RELATION TO THE SUPPLY OF ALCOHOL

1. In accordance with section 19 of the Licensing Act 2003, where a premises licence authorises the supply of alcohol, the licence must include the following conditions.
2. The first condition is that no supply of alcohol may be made under the premises licence -
 - (a) at a time where there is no designated premises supervisor in respect of the premises licence, or
 - (b) at a time when the designated premises supervisor does not hold a personal licence or his personal licence is suspended.
3. The second condition is that every supply of alcohol under the premises licence must be made or authorised by a person who holds a personal licence.
4. (1) The responsible person must ensure that staff on relevant premises do not carry out, arrange or participate in any irresponsible promotions in relation to the premises.
(2) In this paragraph, an irresponsible promotion means any one or more of the following activities, or substantially similar activities, carried on for the purpose of encouraging the sale or supply of alcohol for consumption on the premises -
 - (a) games or other activities which require or encourage, or are designed to require or encourage individuals to -
 - (i) drink a quantity of alcohol within a time limit (other than to drink alcohol sold or supplied on the premises before the cessation of the period in which the responsible person is authorised to sell or supply alcohol), or
 - (ii) drink as much alcohol as possible (whether within a time limit or otherwise);
 - (b) provision of unlimited or unspecified quantities of alcohol free or for a fixed or discounted fee to the public or to a group defined by a particular characteristic in a manner which carries a significant risk of undermining a licensing objective;
 - (c) provision of free or discounted alcohol or any other thing as a prize to encourage or reward the purchase and consumption of alcohol over a period of 24 hours or less in a manner which carries a significant risk of undermining a licensing objective;
 - (d) selling or supplying alcohol in association with promotional posters or flyers on, or in the vicinity of, the premises which can reasonably be considered to condone, encourage or glamorise anti-social behaviour or to refer to the effects of drunkenness in any favourable manner;
 - (e) dispensing alcohol directly by one person into the mouth of another (other than where that other person is unable to drink without assistance by reason of disability).
5. The responsible person must ensure that free potable water is provided on request to customers where it is reasonably available.
6. (1) The premises licence holder or club premises certificate holder must ensure that an age verification policy is adopted in respect of the premises in relation to the sale or supply of alcohol.
(2) The designated premises supervisor in relation to the premises licence must ensure that the supply of alcohol at the premises is carried on in accordance with the age verification policy.

(3) The policy must require individuals who appear to the responsible person to be under 18 years of age (or such older age as may be specified in the policy) to produce on request, before being served alcohol, identification bearing their photograph, date of birth and either

- (a) a holographic mark, or
- (b) an ultraviolet feature.

7. The responsible person must ensure that –
- (a) where any of the following alcoholic drinks is sold or supplied for consumption on the premises (other than alcoholic drinks sold or supplied having been made up in advance ready for sale or supply in a securely closed container) it is available to customers in the following measures –
 - (i) beer or cider: ½ pint;
 - (ii) gin, rum, vodka or whisky: 25ml or 35ml; and
 - (iii) still wine in a glass: 125ml;
 - (b) these measures are displayed in a menu, price list or other printed material which is available to customers on the premises; and
 - (c) where a customer does not in relation to a sale of alcohol specify the quantity of alcohol to be sold, the customer is made aware that these measures are available.

MANDATORY CONDITION: ALCOHOL PRICING

1. A relevant person shall ensure that no alcohol is sold or supplied for consumption on or off the premises for a price which is less than the permitted price.
2. For the purposes of the condition set out in paragraph 1 –
 - (a) "duty" is to be construed in accordance with the Alcoholic Liquor Duties Act 1979(6);
 - (b) "permitted price" is the price found by applying the formula –
$$P = D + (D \times V)$$
where –
 - (i) P is the permitted price,
 - (ii) D is the rate of duty chargeable in relation to the alcohol as if the duty were charged on the date of the sale or supply of the alcohol, and
 - (iii) V is the rate of value added tax chargeable in relation to the alcohol as if the value added tax were charged on the date of the sale or supply of the alcohol;
 - (c) "relevant person" means, in relation to premises in respect of which there is in force a premises licence –
 - (i) the holder of the premises licence,
 - (ii) the designated premises supervisor (if any) in respect of such a licence, or
 - (iii) the personal licence holder who makes or authorises a supply of alcohol under such a licence;
 - (d) "relevant person" means, in relation to premises in respect of which there is in force a club premises certificate, any member or officer of the club present on the premises in a capacity which enables the member or officer to prevent the supply in question; and
 - (e) "value added tax" means value added tax charged in accordance with the Value Added Tax Act 1994(7).

3. Where the permitted price given by Paragraph (b) of paragraph 2 would (apart from this paragraph) not be a whole number of pennies, the price given by that sub-paragraph shall be taken to be the price actually given by that sub-paragraph rounded up to the nearest penny.

4. (1) Sub-paragraph (2) applies where the permitted price given by Paragraph (b) of paragraph 2 on a day ("the first day") would be different from the permitted price on the next day ("the second day") as a result of a change to the rate of duty or value added tax.

(2) The permitted price which would apply on the first day applies to sales or supplies of alcohol which take place before the expiry of the period of 14 days beginning on the second day.

Embedded Restrictions

STANDARD PRE-EXISTING CONDITIONS APPLICABLE TO ON LICENCE WITH NO CHILDREN'S CERTIFICATE AND SUPPER HOURS CERTIFICATE

On Licence with no Children's Certificate

Permitted Hours

1. Alcohol shall not be sold or supplied except during permitted hours. In this condition permitted hours means:

- a) On weekdays (other than Christmas Day or Good Friday) 10:00 to 23:00
- b) On Sundays (other than Christmas Day) 12:00 to 22:30
- c) On Good Friday, 12:00 to 22:30
- d) On Christmas Day, 12:00 to 15:00 and 19:00 to 22:30
- e) On New Year's Eve from the end of the permitted hours on New Year's Eve to the start of permitted hours on the following day (or if there are no permitted hours on the following day, midnight on 31 December).

The above restrictions do not prohibit:

- a) during the first twenty minutes after the above hours the consumption of alcohol on the premises
- b) during the first twenty minutes after the above hours, the taking of alcohol from the premises unless the alcohol is supplied or taken away in an open vessel
- c) during the first thirty minutes after the above hours, the consumption of the alcohol on the premises by persons taking meals there if the alcohol was supplied for consumption as an ancillary to the meals.
- d) the sale or supply of alcohol to, or consumption of alcohol by, any person residing at the licensed premises
- e) the ordering of alcohol to be consumed off the premises, or the dispatch by the vendor of the alcohol so ordered
- f) the sale of alcohol to a trader for the purposes of his trade, or to a registered club for the purposes of the club
- g) the sale or supply of alcohol to any canteen or mess, being a canteen in which the sale or supply of alcohol is carried out under the authority of the Secretary of State or an authorised mess of members of Her Majesty's naval, military or air forces

- h) the taking of alcohol from the premises by a person residing there
- i) the supply of alcohol for consumption on the premises to any private friends of a person residing there who are bona fide entertained by him at his own expense, or the consumption of alcohol by persons so supplied
- j) the supply of alcohol for consumption on the premises to persons employed there for the purposes of the business carried on by the holder of the licence, or the consumption of liquor so supplied, if the liquor is supplied at the expense of their employer or of the person carrying on or in charge of the business on the premises.

Children

2. No person under fourteen shall be allowed in the bar of the licensed premises during the permitted hours unless one of the following applies:

- a) He is the child of the holder of the premises licence
- b) He resides in the premises, but is not employed there
- c) He is in the bar solely for the purpose of passing to or from some part of the premises which is not a bar and to or from which there is no other convenient means of access or egress
- d) The bar is in railway refreshment rooms or other premises constructed, fitted and intended to be used bona fide for any purpose to which the holding of the licence is merely ancillary.

In this condition bar includes any place exclusively or mainly used for the sale and consumption of intoxicating liquor, but does not include a bar at any time when it is usual in the premises in question for it to be, and it is -

- i) set apart for the service of table meals, and
- ii) not used for the sale or supply of intoxicating liquor otherwise than to persons having table meals there and for consumption by such a person as an ancillary to his meal.

Credit Sales

3. Intoxicating liquor shall not be sold or supplied for consumption on the premises unless it is paid for before or at the time when it is sold or supplied. This condition, however, shall not apply:

- a) If the liquor is sold or supplied for consumption at a meal supplied at the same time, is consumed with the meal and is paid for together with the meal or
- b) If the liquor is sold or supplied for consumption by a person residing in the premises or his guests and is paid for together with his accommodation, or
- c) If the sale or supply of intoxicating liquor is to any canteen in which the sale or supply of alcohol is carried out under the authority of the Secretary of State or to an authorised mess of members of Her Majesty's naval, military or air forces.

Other Conditions

4. CCTV cameras are to be installed covering the outside and the inside of the premises after consultation with the police. Recordings shall be kept for 31 days and be made available to the police for evidential purposes. The system will record round the clock and the time and date of the recording will appear on the tape.
5. Substantial food shall be available at all times the premises are open.
6. There shall be no amusement with prizes machines, no amusement only machines, and no pool tables and dart boards on the premises.
7. There shall be no change in the current style of operation.
8. Discounting of alcoholic drinks will only take place as part of promotion organised by the Pelican Group Plc or their parent company Whitbread.
9. There shall be no disc jockey, and music shall only be by way of background music controlled by members of staff from behind the bar.
10. Seating for not less than 80 persons shall be provided at all times.
11. The maximum number of customers permitted on the premises at any one time shall not exceed the number fixed by the Fire and Rescue Service.
12. There shall be no television entertainment, no videos and no live broadcasts.
13. Alcohol will only be served to persons seated at tables or at the bar or to no more than 10 people standing at the bar by way of waiter/waitress service only.
14. The following requirements shall be complied with;
 - (a) To operate the early warning system (Pubwatch) on an approved electronic pager.
 - (b) To comply with any instructions issued by the police and justices regarding closures on race days and/or other sporting events.
 - (c) To ensure that when an exclusion order is made the person subject to the order is denied access to your premises.

Supper Hours

1. Alcohol may be sold or supplied [for one hour following the hours set out above] and [on Christmas Day, between 15:00 and 19:00] to persons taking table meals in the premises in a part of the premises usually set apart for the service of such persons and for the consumption by such a person in that part of the premises as an ancillary to his meal. For other purposes, or in other parts of the premises, the normal permitted hours as set out above shall continue to apply.

Recorded Music

Recorded music may be played throughout the premises without limitation in line with previous provisions as set out in Section 182 of the Licensing Act 1964.

Late Night Refreshment

The licence holder may also provide and permit the consumption of late night refreshment for a period of 30 minutes after the permitted hours set out above.

Private Entertainment

As the provisions of the Private Places of Entertainment (Licensing) Act 1967 was previously adopted and applied throughout the City of York Council area, private entertainment for gain may be provided throughout the premises without limitation by virtue of the previous Justices Licence.

Annex 2 – Conditions consistent with the operating schedule

Licensing Objectives

None

Annex 3 – Conditions attached after a hearing by the licensing authority

No hearing held

Annex 4 – Approved Plan

Plan Number's 12035 101A LS

For and on behalf of
The Director of Economy & Place

Licensing Services
Hazel Court EcoDepot
James Street
York
YO10 3DS

Date: 15/08/2005
03/12/2020 (Transfer)

Phone: 01904 552422
Fax: 01904 551590
Email: licensing@york.gov.uk
Website: www.york.gov.uk/licensing



PREMISES LICENCE SUMMARY

Part B

Part 1 Premises details

Premises licence number
CYC - 009267

Postal address of premises:

52 Low Petergate

Post town: **York**

Post code: **YO1 7HZ**

Telephone number: 01904 673293

Where the licence is time limited the date:

This licence has no expiry date.

Licensable activities authorised by the licence:

Recorded Music
Late Night Refreshment
Supply of Alcohol

The times the licence authorises the carrying out of licensable activities:

Supply of Alcohol:

- a) On weekdays (other than Christmas Day or Good Friday) 10:00 to 23:00
- b) On Sundays (other than Christmas Day) 12:00 to 22:30
- c) On Good Friday, 12:00 to 22:30
- d) On Christmas Day, 12:00 to 15:00 and 19:00 to 22:30
- e) On New Year's Eve from the end of the permitted hours on New Year's Eve to the start of permitted hours on the following day (or if there are no permitted hours on the following day, midnight on 31 December).

The above restrictions do not prohibit:

- a) during the first twenty minutes after the above hours the consumption of alcohol on the premises
- b) during the first twenty minutes after the above hours, the taking of alcohol from the premises unless the alcohol is supplied or taken away in an open vessel
- c) during the first thirty minutes after the above hours, the consumption of the alcohol on the premises by persons taking meals there if the alcohol was supplied for consumption as an ancillary to the meals.
- d) the sale or supply of alcohol to, or consumption of alcohol by, any person residing at the licensed premises
- e) the ordering of alcohol to be consumed off the premises, or the dispatch by the vendor of the alcohol so ordered
- f) the sale of alcohol to a trader for the purposes of his trade, or to a registered club for the purposes of the club
- g) the sale or supply of alcohol to any canteen or mess, being a canteen in which the sale or supply of alcohol is carried out under the authority of the Secretary of State or an authorised mess of members of Her Majesty's naval, military or air forces
- h) the taking of alcohol from the premises by a person residing there
- i) the supply of alcohol for consumption on the premises to any private friends of a person residing there who are bona fide entertained by him at his own expense, or the consumption of alcohol by persons so supplied
- j) the supply of alcohol for consumption on the premises to persons employed there for the purposes of the business carried on by the holder of the licence, or the consumption of liquor so supplied, if the liquor is supplied at the expense of their employer or of the person carrying on or in charge of the business on the premises.

Supper Hours

Alcohol may be sold or supplied [for one hour following the hours set out above] and [on Christmas Day, between 15:00 and 19:00] to persons taking table meals in the premises in a part of the premises usually set apart for the service of such persons and for the consumption by such a person in that part of the premises as an ancillary to his meal. For other purposes, or in other parts of the premises, the normal permitted hours as set out above shall continue to apply.

Recorded Music

Recorded music may be played throughout the premises without limitation in line with previous provisions as set out in Section 182 of the Licensing Act 1964.

Late Night Refreshment

The licence holder may also provide and permit the consumption of late night refreshment for a period of 30 minutes after the permitted hours set out above.

The Opening Hours of the Premises

No Restrictions

Where the licence authorises supplies of alcohol whether these are on and/or off supplies:

On and off the premises

Name and (registered) address of holder of premise licence:

Name: Jimmy's York Limited

Address: First Floor
17-19 Foley Street
London
W1W 6DW

Registered number of holder, for example company number, charity number (where applicable):

12882634

Name of designated premises supervisor where the premise licence authorises the supply of alcohol:

Andrea Gaiga

State whether access to the premises by children is restricted or prohibited

No person under fourteen shall be allowed in the bar of the licensed premises during the permitted hours unless one of the following applies:

- a) He is the child of the holder of the premises licence
- b) He resides in the premises, but is not employed there
- c) He is in the bar solely for the purpose of passing to or from some part of the premises which is not a bar and to or from which there is no other convenient means of access or egress
- d) The bar is in railway refreshment rooms or other premises constructed, fitted and intended to be used bona fide for any purpose to which the holding of the licence is merely ancillary.

In this condition bar includes any place exclusively or mainly used for the sale and consumption of intoxicating liquor, but does not include a bar at any time when it is usual in the premises in question for it to be, and it is -

- i) set apart for the service of table meals, and
- ii) not used for the sale or supply of intoxicating liquor otherwise than to persons having table meals there and for consumption by such a person as an ancillary to his meal.

For and on behalf of
The Director of Economy & Place

Date: 15/08/2005
03/12/2020 (Transfer)

Licensing Services
Hazel Court EcoDepot
James Street
York
YO10 3DS

Phone: 01904 552422
Fax: 01904 551590
Email: licensing@york.gov.uk
Website: www.york.gov.uk/licensing

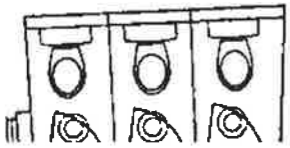

RECEIVED
 13 FEB 2015
 SOCKEN

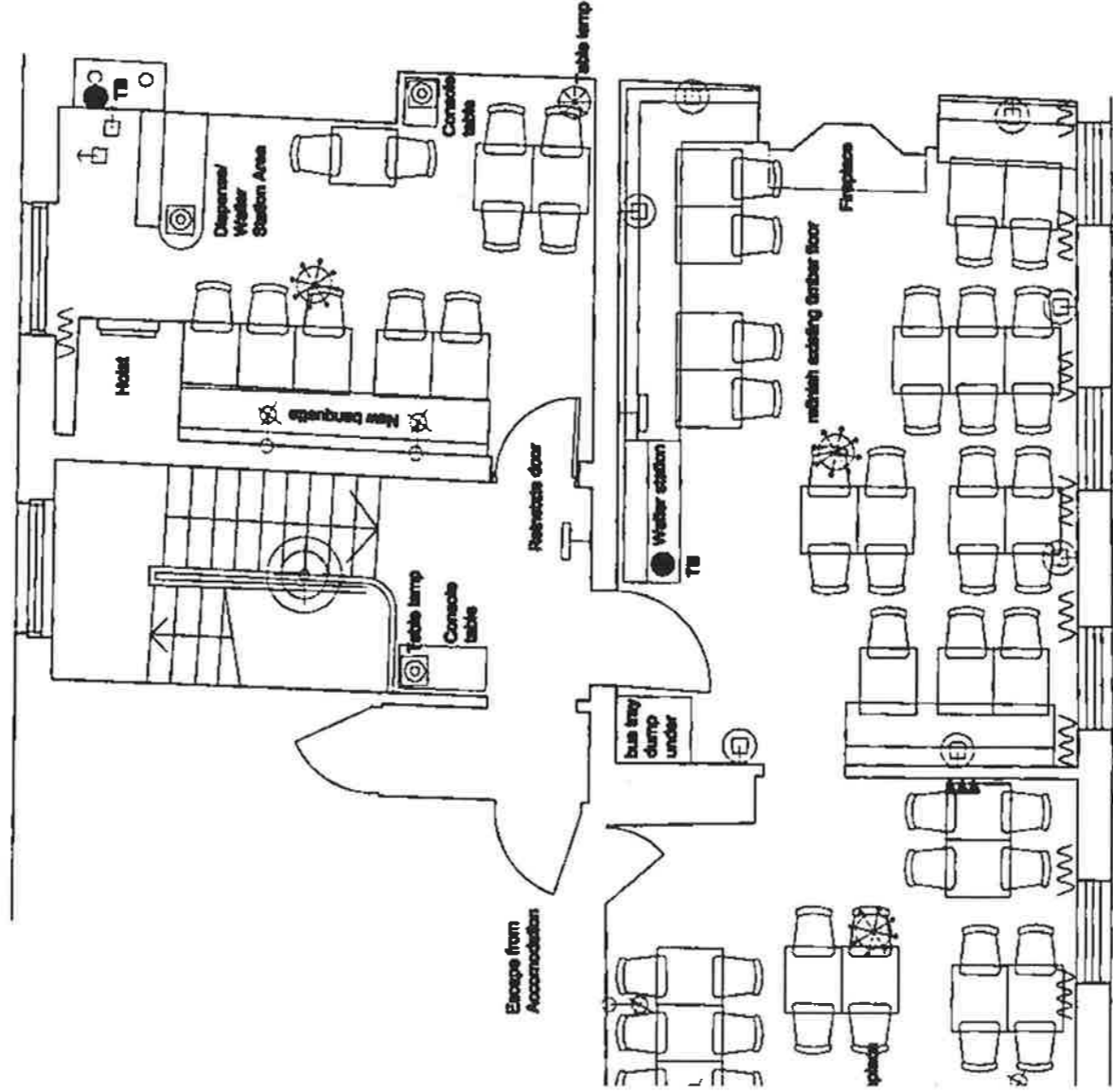

NOTES:-

1. All drawings to be read in conjunction with Structural Engineer's details & any relevant sub-contractor's details. All works to comply with current Building Regulations, British Standards & Codes of Practice.
2. The Main Contractor & Sub-Contractor where applicable will be responsible for checking all dimensions on site & reporting any discrepancies to all relevant consultants.
3. The contractor must familiarize himself with the site and measure all areas affecting his work. All dimensions must be verified on site prior to manufacture of any joinery or works on or off site.
4. All works to be carried out by approved installation contractors, and to manufacturers recommendations.
5. All dimensions to be in millimeters.
6. Contractor to ensure that all work meets the requirements of the EHC, Building Control, Fire Authority and all other statutory bodies.
7. All shop-fit decoration to achieve Class 'O' surface spread of 'same' in accordance with BS478, Part 7.
8. All stained timber areas to be treated with Thermoguard or similar to achieve Class 'O' surface spread of same. All painted timber areas to be treated with Thermoguard Timbercoat or similar to achieve Class 'O' surface spread of same.
9. Where MDF is specified this is to be Zero or Low Formaldehyde type MDF made to British Standards.
10. The contractor is to ensure that all walls to be decorated are prepared prior to decoration and all surfaces smooth level and joint free. All applied coatings are to be water based to large wall areas. Contractor to allow for one mist coat and two top coats in corners, walls and timberworks.

All new timber to be pressure impregnated with preservative prior to delivery to site. Where subsequent cutting & bonding is necessary all exposed faces to be coated with Protim.

REVISIONS

REV	DATE	DESCRIPTION
A	02.02.15	NOTES AMENDED



BOW STREET, BIRMINGHAM B1 1DW
 Telephone 0121 666 6867
 brook.milard@keanebrands.com

CLIENT Tragus
PROJECT Cafe Rouge - York
DRG TITLE Proposed Plan- Preliminary
SCALE 1:100 @ A1
DATE 11.11.14 **DRN BY** LS
JOB NO 12035 **DRG NO** 101 A

	EXISTING	PROPOSED
GROUND FLOOR	62	62
FIRST FLOOR	62	67
EXTERNAL	24	28
TOTALS	138	147

This drawing is the property of Keane Design Associates. Copyright is reserved by them and the drawings are on condition that they are not copied either wholly or in part without the consent in writing of Keane Design Associates. All dimensions are to take preference over those scaled. All dimensions to be checked on site prior to commencement of any work or shop drawings. This drawing is to be read in conjunction with the specification where relevant.

